



**Power Underbody Clamp
With Removable Location
Pin, Locking, Handle to
remove clamp in event of
air failure**

Dry air is
permissible
Restrictors must
be used in conjunction
with cylinder

Pin Sizes X:

16 - 30 dia
Smaller and larger sizes
available

Panel Gap Y (grip range):

0 - 5 mm
larger sizes available

Sensing options

ES 1 Inductive Switches
ES 3 Inductive Switches
(Rev)

Adjustment Screw

XLPV-1 (as shown)
XLPV-9 (where indicated)

Special Pins & Mounting

Available on request,
examples below

Models & Part Codes

Contact us with your
requirements, pin size,
panel gap and any
special requirements
and we create
model and part
code.

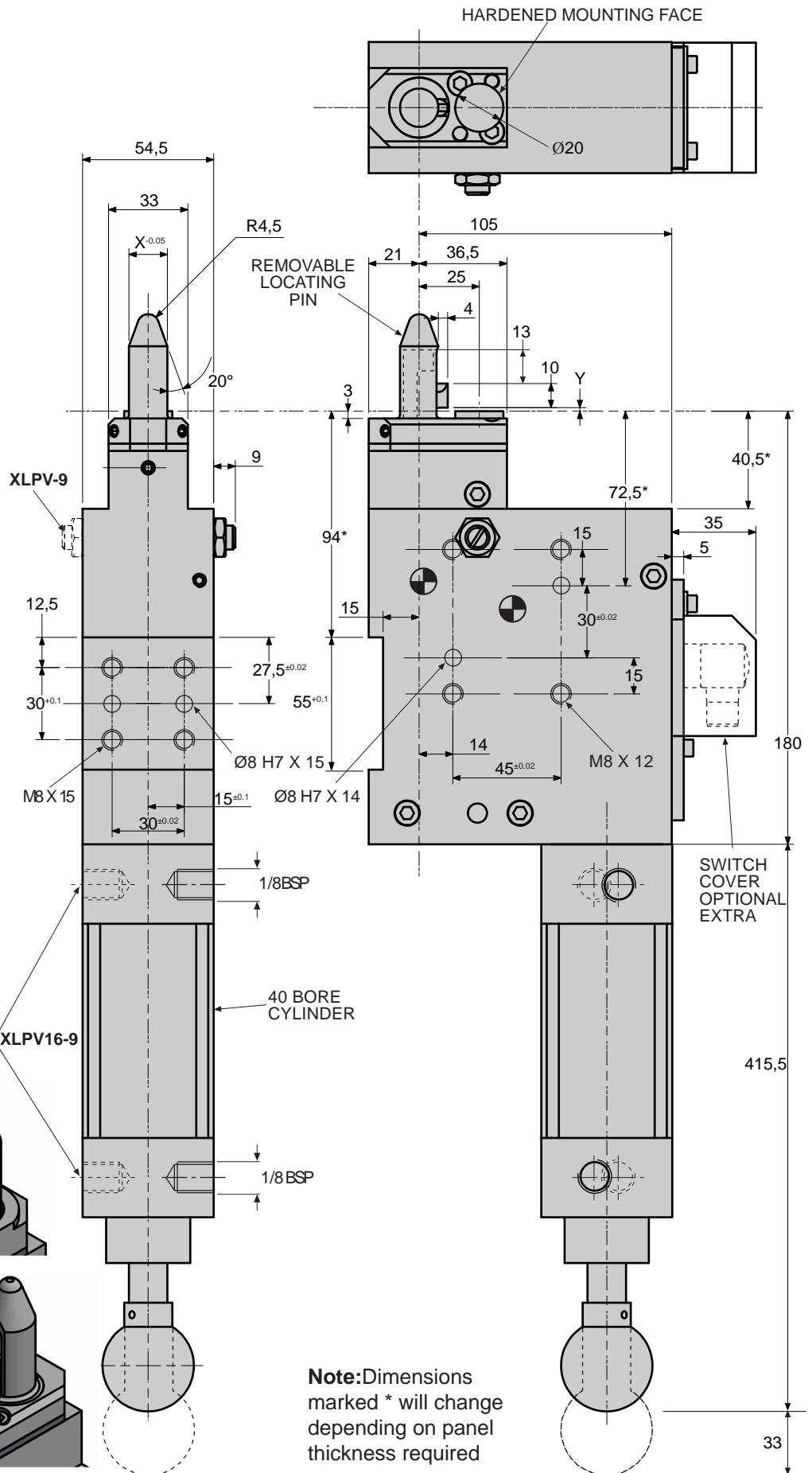
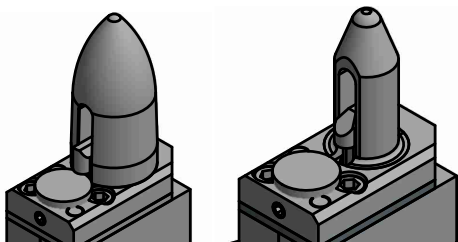
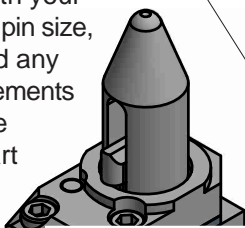

Note: Dimensions
marked * will change
depending on panel
thickness required