

HOOK CLAMP

HC24V

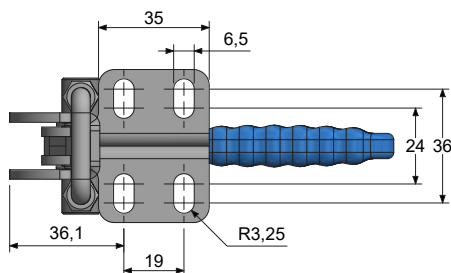

Material: Heavy gauge steel
Finish: Zinc plated
Supplied with: Hook, Latch plate
Max holding force: 410daN
Weight: HC24/V-100 - 0.3Kgs
 HC24/V-150 -
 HC24/V-200
Clamping pressure:

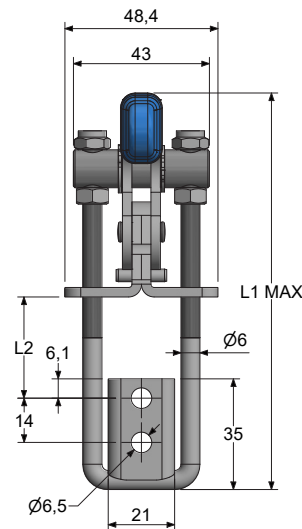
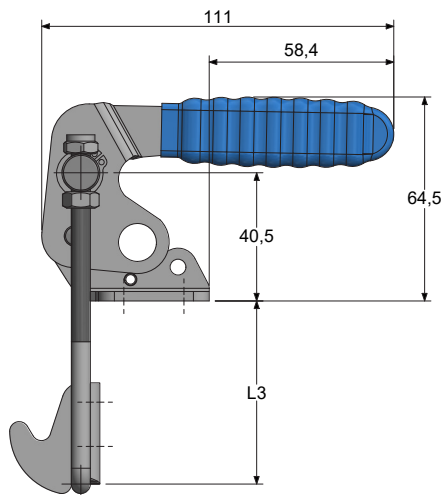
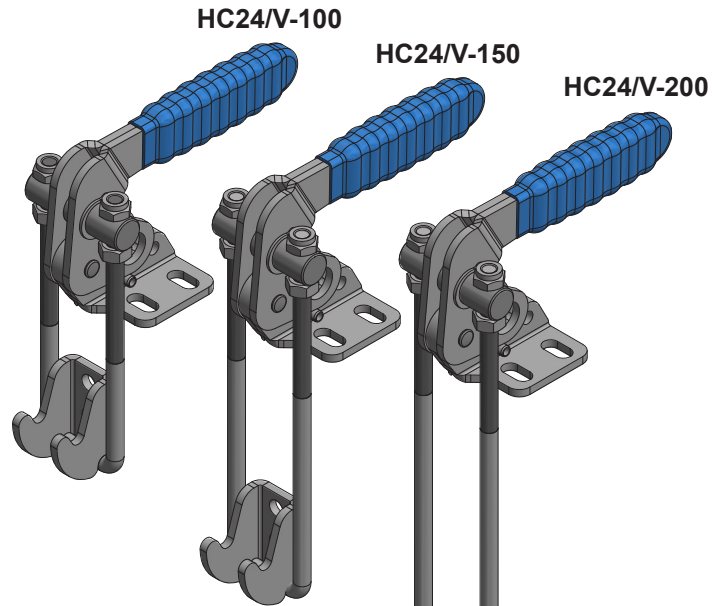
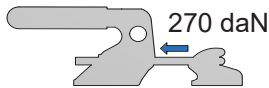

PART No.	DIM `L1`	DIM `L2`	DIM `L3`
HC24/V-100	125	7-32	32.5-57.5
HC24/V-150	162	27-69	52.5-94.5
HC24/V-200	212	77-119	102.5-144.5

HC24/V-SS
 Stainless steel
 option available