

# TOGGLE PRESS

# PR95

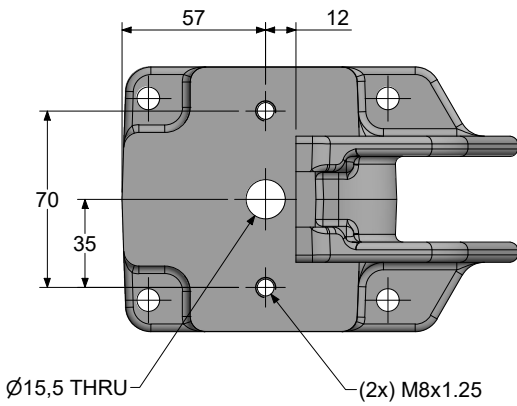

**Material:** Heavy gauge steel  
**Finish:** Chemi blacked  
**Supplied with:** M8x65mm spindle  
**Max holding force:** 600daN  
**Weight:** 3.65Kgs  
**Stroke:** 32mm  
**Clamping pressure:** Maximum clamping force is generated just before plunger reaches full extension

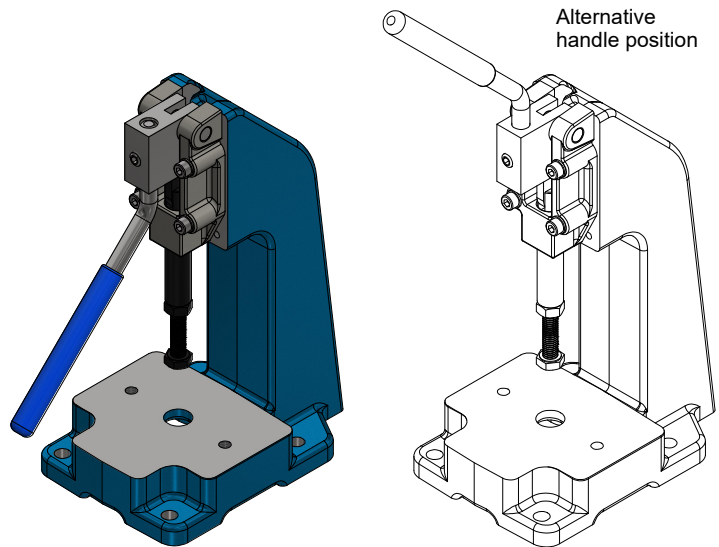
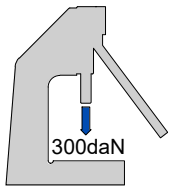

View without clamp

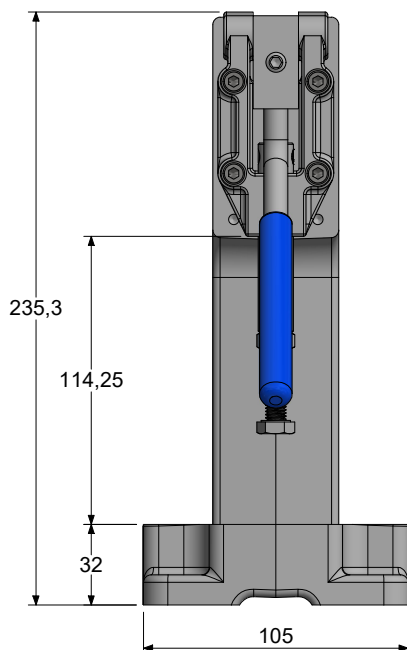
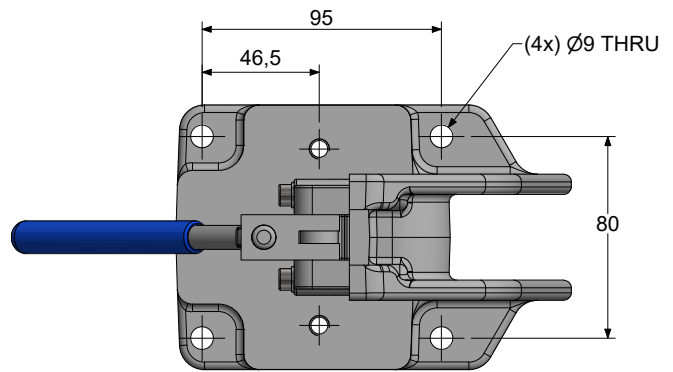

Clamp can be moved up and down by 18.25 mm

